

# INSTALLATION GUIDE

## CANOPY - LINEAR FLUSH

TWIN MAGICAL

LFS.TWIN.M / LFL.TWIN.M

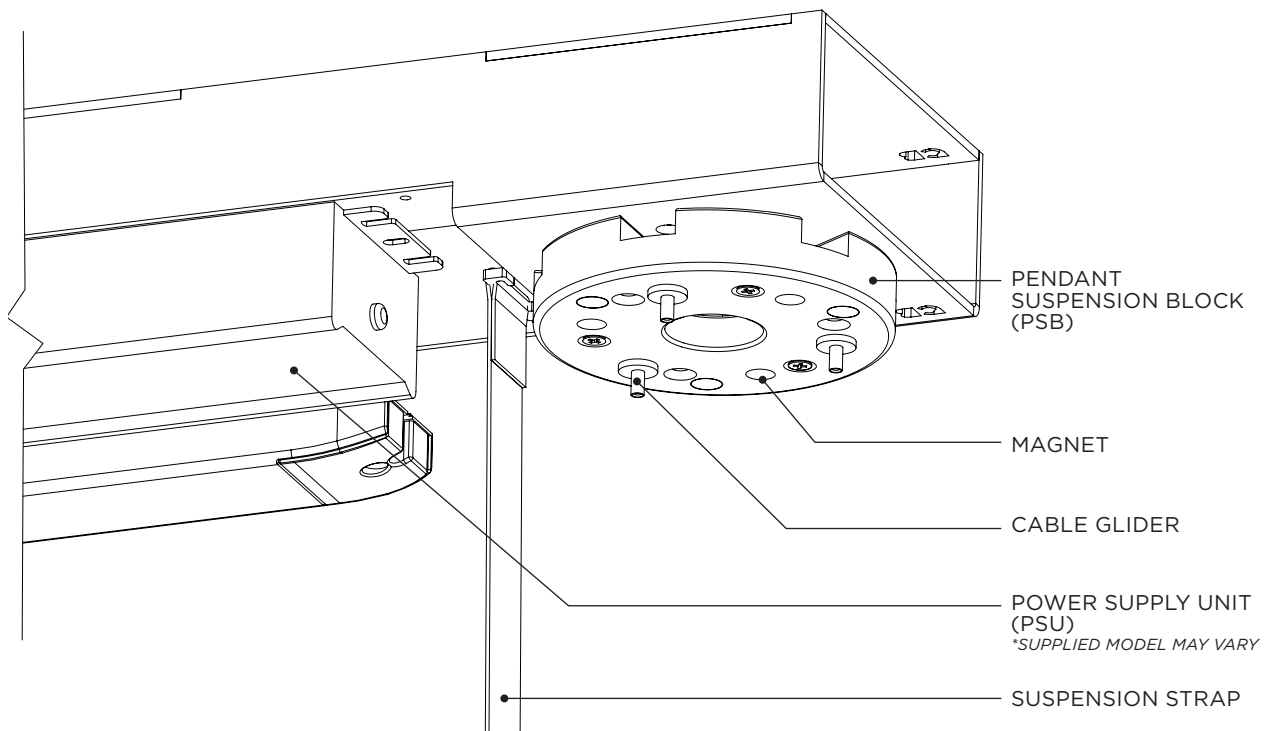
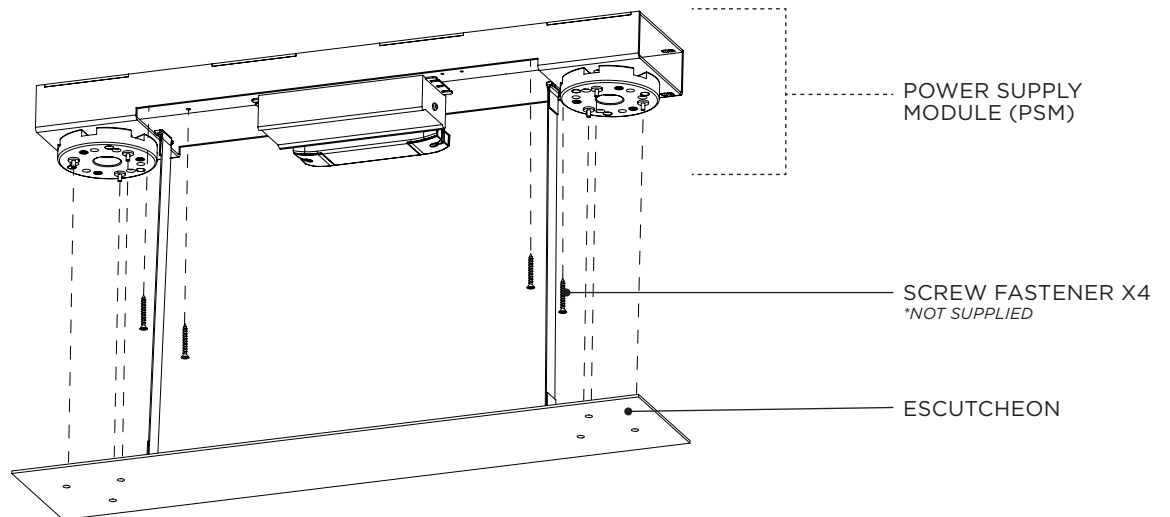

# INSTALLATION GUIDE

## CANOPY - LINEAR FLUSH

TWIN MAGICAL  
LFS.TWIN.M / LFL.TWIN.M



### **WARNING: SHOCK HAZARD**

May result in serious injury or death.  
ENSURE POWER IS OFF before commencing any work.



### **WARNING: ELECTRICAL**

ALL ELECTRICAL connections must be made by a qualified electrician in accordance with the regulations and codes governing the area for which the CHRISTOPHER BOOTS Fixture is intended to be installed in. Failure to do so may result in serious harm or damage to property and life, at the owner's liability and expense.

CHRISTOPHER BOOTS will not be held liable for any damage caused from installation.



### **WARNING: STRUCTURAL**

Ensure that the substrate is securely installed and is in accordance with local building regulations. Failure to do so may potentially result in serious harm or damage of property, at the owner's liability and expense.

CHRISTOPHER BOOTS will not be held liable for any damage caused from installation.



Refer to supplied WIRING DIAGRAM.

# INSTALLATION GUIDE

## CANOPY - LINEAR FLUSH

TWIN MAGICAL

LFS.TWIN.M / LFL.TWIN.M

- 1 Wearing gloves, unpack the LINEAR FLUSH CANOPY with care, ensuring not to scratch the surface of the ESCUTCHEON. Separate the ESCUTCHEON from PSM. These are connected via Magnets and can be pulled apart using moderate force.
- 2 Cut a hole in the ceiling for the PSM. The hole should be 130 mm wide, with a length based on the below table.

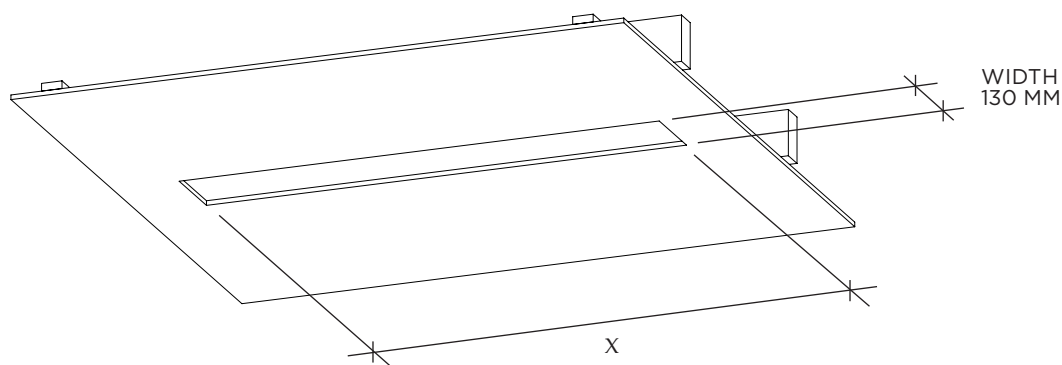

	CODE	DESCRIPTION	CUT LENGTH
X	LFS.TWIN.M	LINEAR FLUSH SMALL . TWIN . MAGICAL	520mm
	LFL.TWIN.M	LINEAR FLUSH LARGE . TWIN . MAGICAL	720mm

- 3 Installer to provide adequate load-bearing substrate, utilising ceiling joists where additional support is required. The mounting face of the substrate must be set back 75mm from the CEILING. For accurate placement of Cable Exits in the Substrate, use the PSM as a guide.

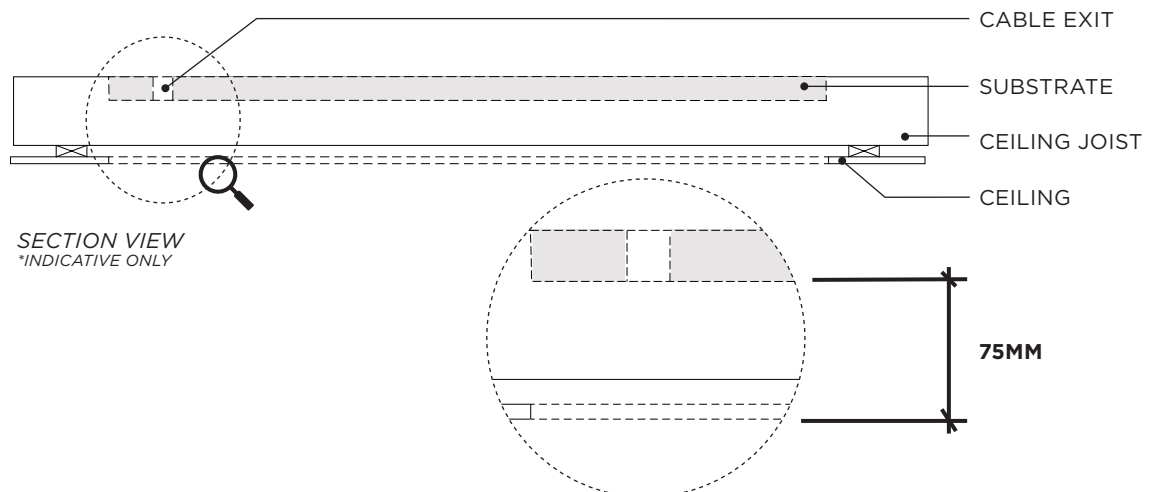

# INSTALLATION GUIDE

## CANOPY - LINEAR FLUSH

TWIN MAGICAL  
LFS.TWIN.M / LFL.TWIN.M

- 4** Prepare the 110-240V AC Power to be connected to the PSU.

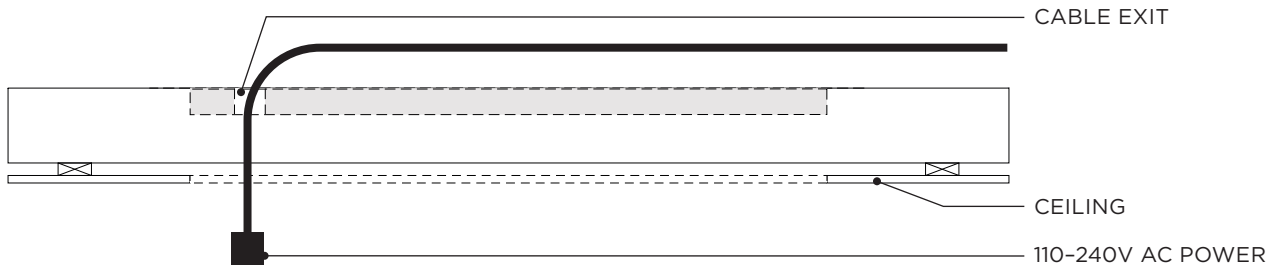

- 5**
- A. Attach the PSM to the prepared Substrate with appropriate Fasteners.
  - B. Ensure the face of the PSB is flush with the CEILING as shown.
  - C. Connect the 110-240V AC Power to the PSU.  
Refer to supplied WIRING DIAGRAM →

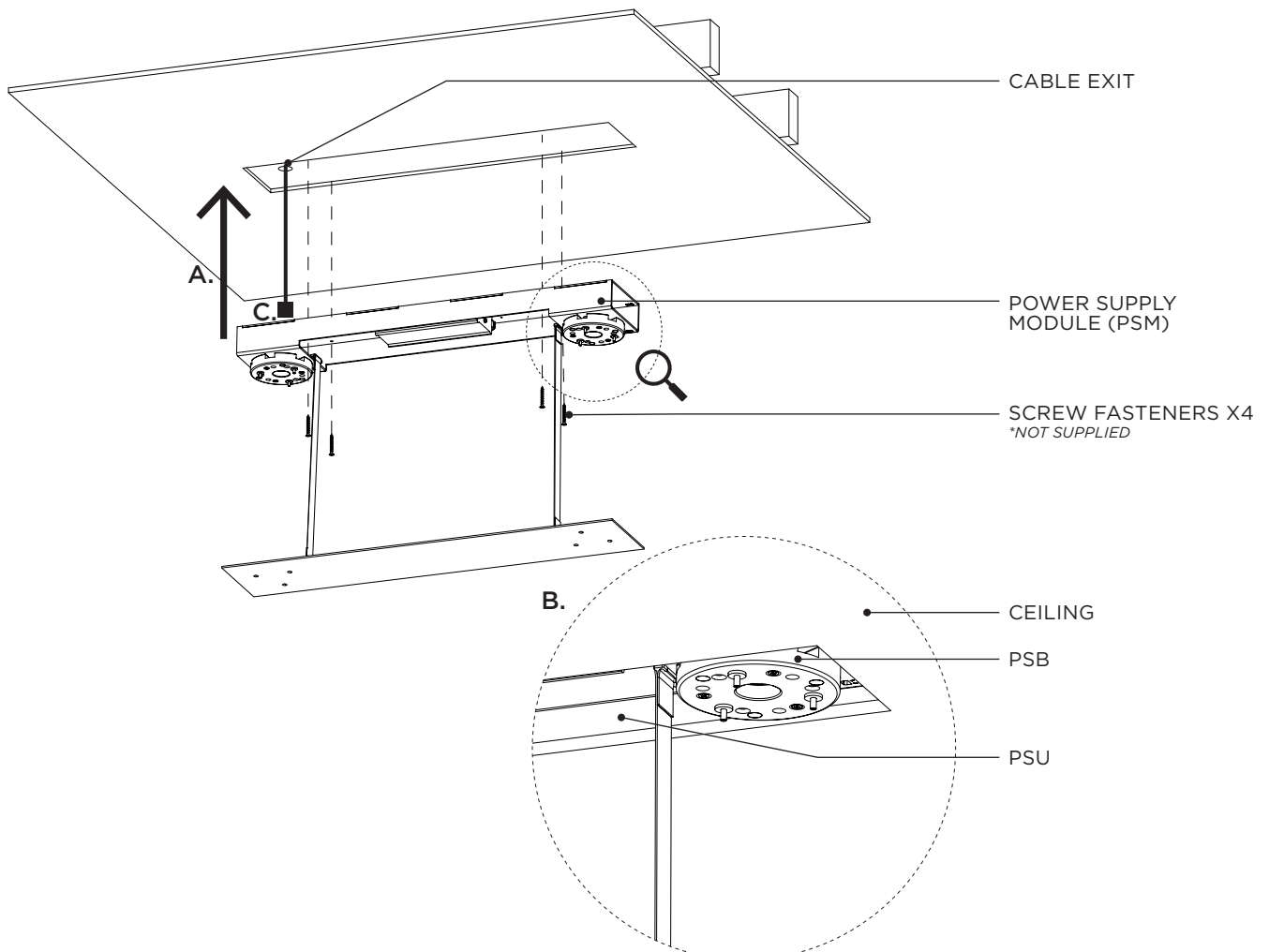

# INSTALLATION GUIDE

## CANOPY - LINEAR FLUSH

TWIN MAGICAL

LFS.TWIN.M / LFL.TWIN.M

- 6** Feed the PENDANT CABLES through the ESCUTCHEON as shown, take note of the labelled cables as they must correspond with the labelled cable gliders.

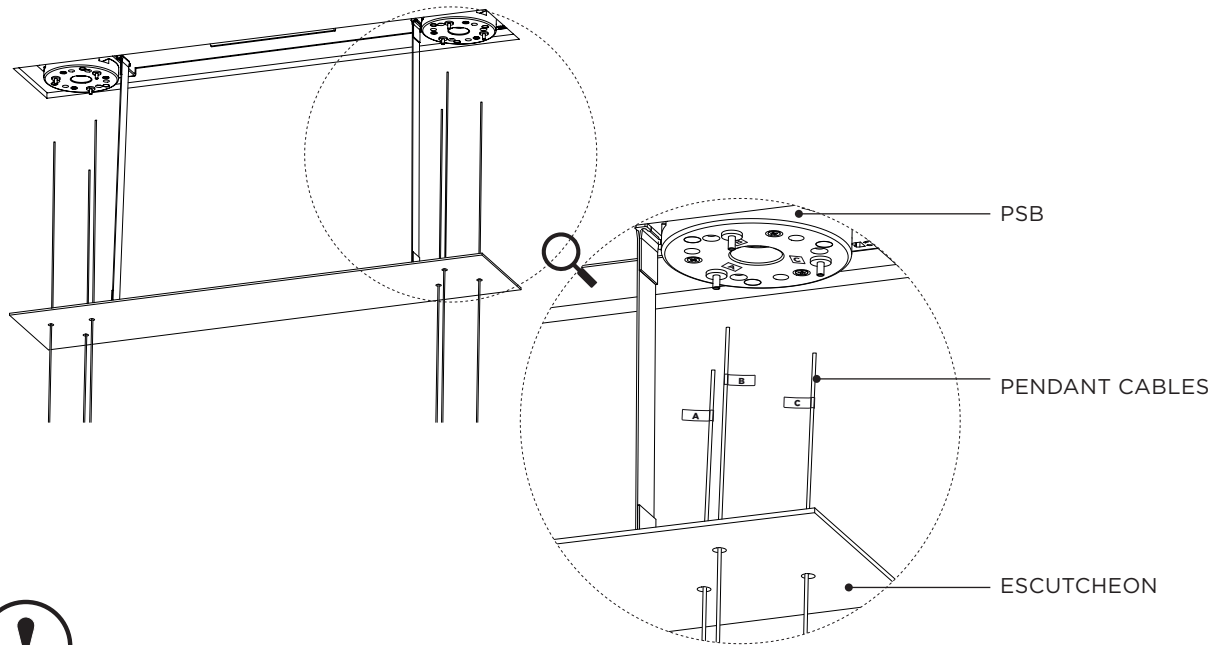

INCORRECTLY MATCHING THE CABLES TO THE GLIDERS WILL RESULT IN AN ELECTRICAL FAULT & CAUSE PRODUCT FAILURE.

- 7** A. Slightly bend the first 10mm of the PENDANT CABLES.  
B. Feed the labelled PENDANT CABLES through the corresponding CABLE GLIDERS, and exit through the cavities.

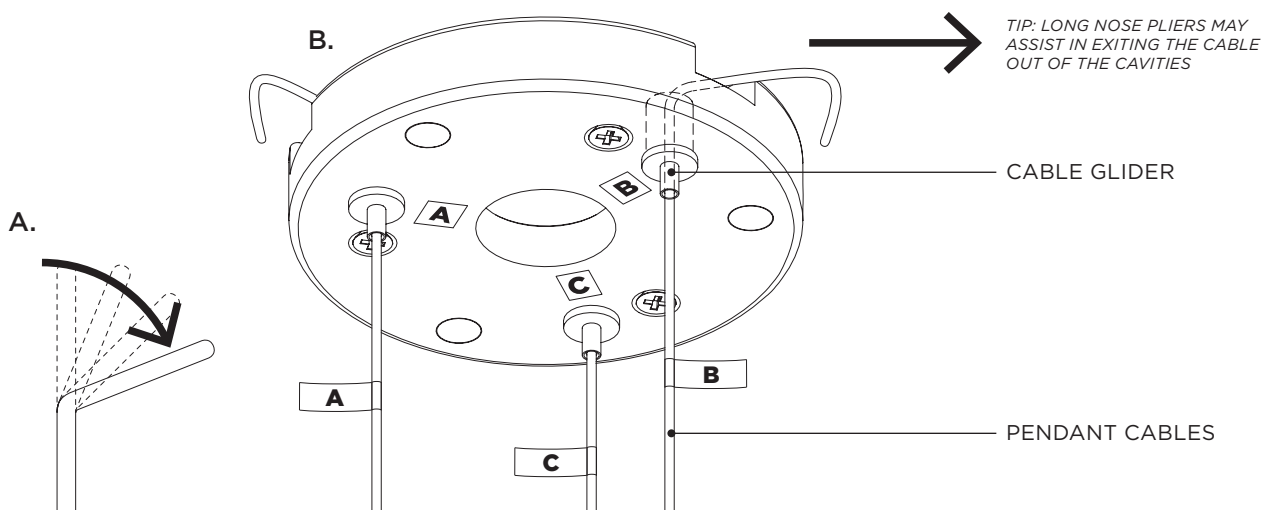

# INSTALLATION GUIDE

## CANOPY - LINEAR FLUSH

TWIN MAGICAL

LFS.TWIN.M / LFL.TWIN.M

- 8**
- A. Raise the PENDANT, feeding excess cable through the CABLE GLIDERS. Set into position by gently lowering the PENDANT.
  - B. While supporting the pendant make necessary adjustments; To lower, press the cable gliders gently allowing excess cable to slide downwards. To raise, gently feed the cables up through the cable gliders. When satisfied with arrangement, ensure that neither the PENDANT or SUSPENSION components are touching.

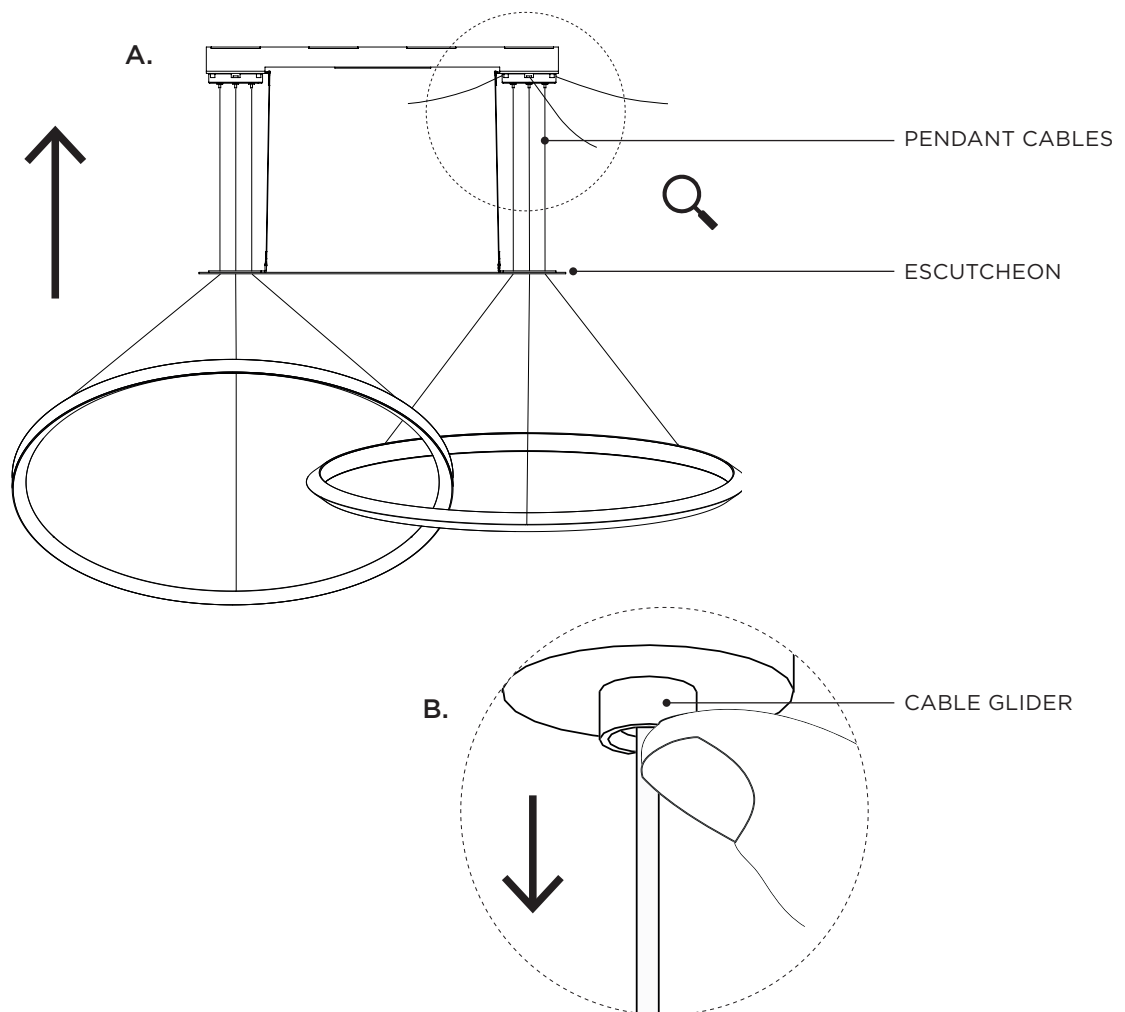

- 9**
- Connect the labelled PENDANT CABLES to the PSU.  
Refer to supplied WIRING DIAGRAM →



# INSTALLATION GUIDE

## CANOPY - LINEAR FLUSH

TWIN MAGICAL  
LFS.TWIN.M / LFL.TWIN.M

- 10** Carefully raise ESCUTCHEON to the ceiling and push SUSPENSION STRAPS towards the centre until the Magnets engage. Ensure no contact between ESCUTCHEON and CABLE GLIDERS, as this may release the suspension wires.

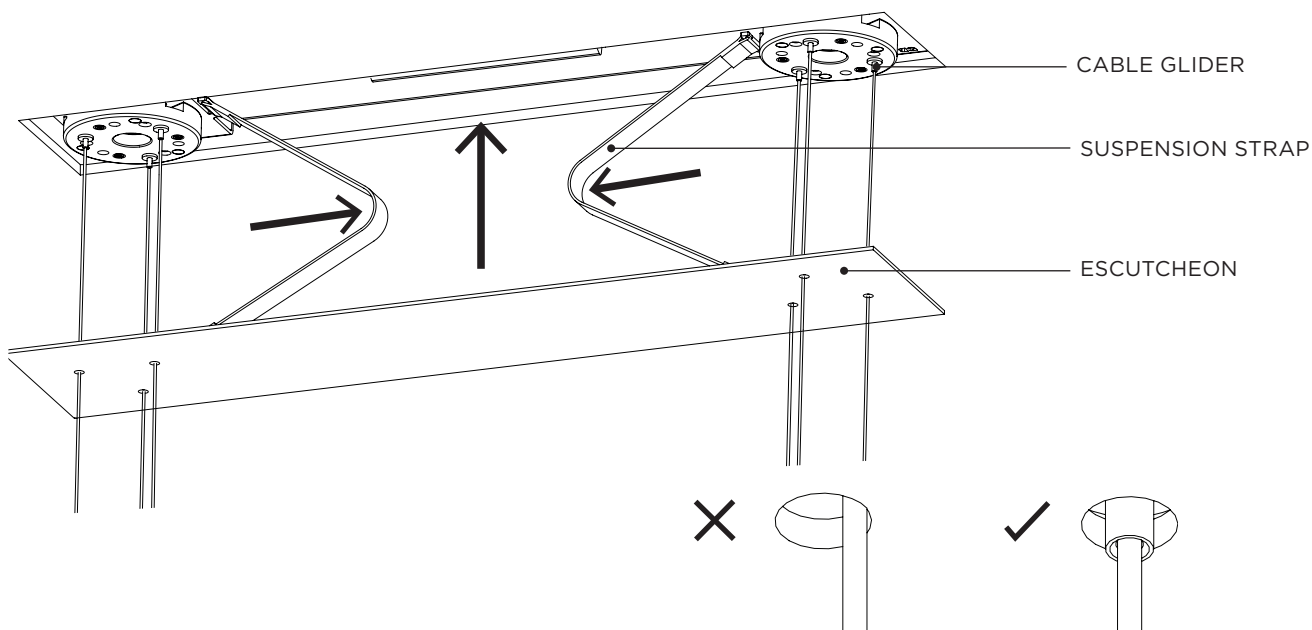

- 11** With the ESCUTCHEON in place, make any necessary final adjustments to the PENDANT.

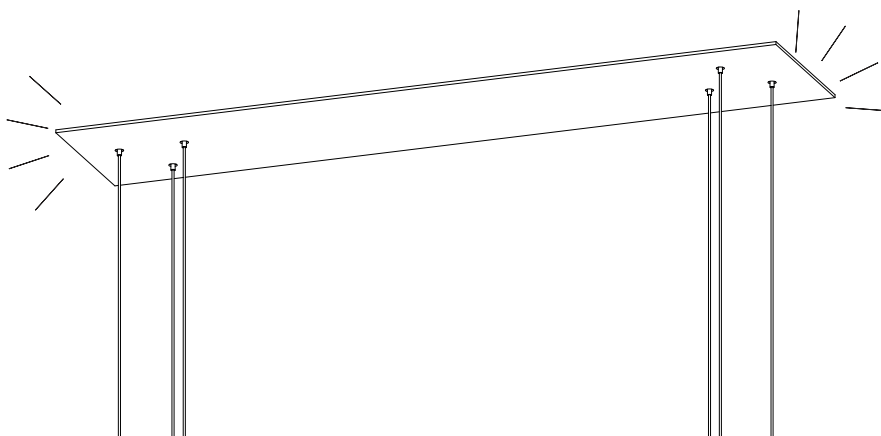

# INSTALLATION GUIDE

## CANOPY - LINEAR FLUSH

TWIN MAGICAL

LFS.TWIN.M / LFL.TWIN.M

- 12 Conduct a final visual assessment of both the canopy and fixture to ensure all parts have been properly fitted and secured. Once satisfied that everything is in working order, remove all remaining protective material which will now complete the installation process.

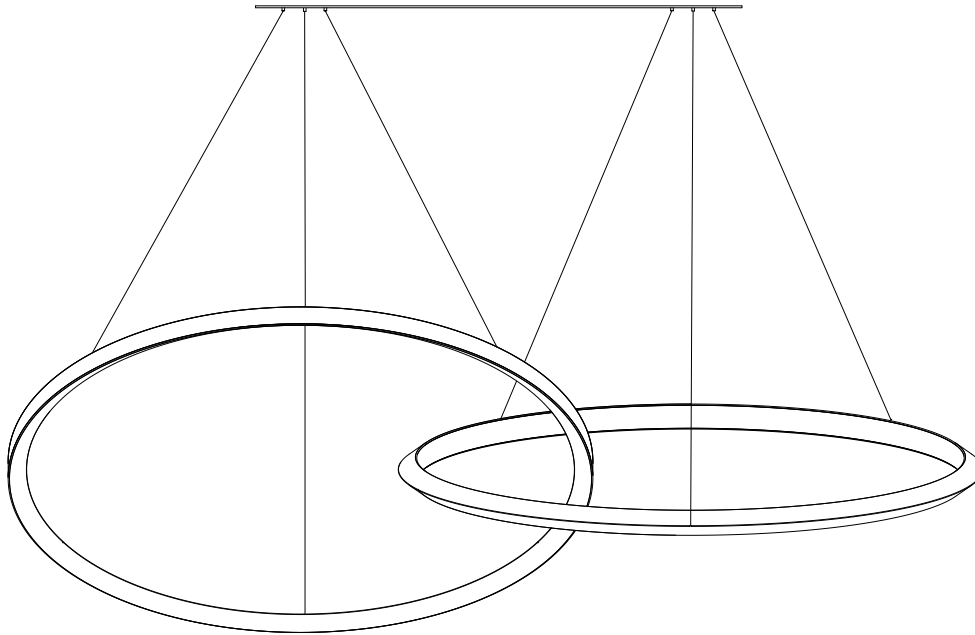

FINISH