

SUGAR BOMB SCONCE MONO STONE

SB.S.M.S

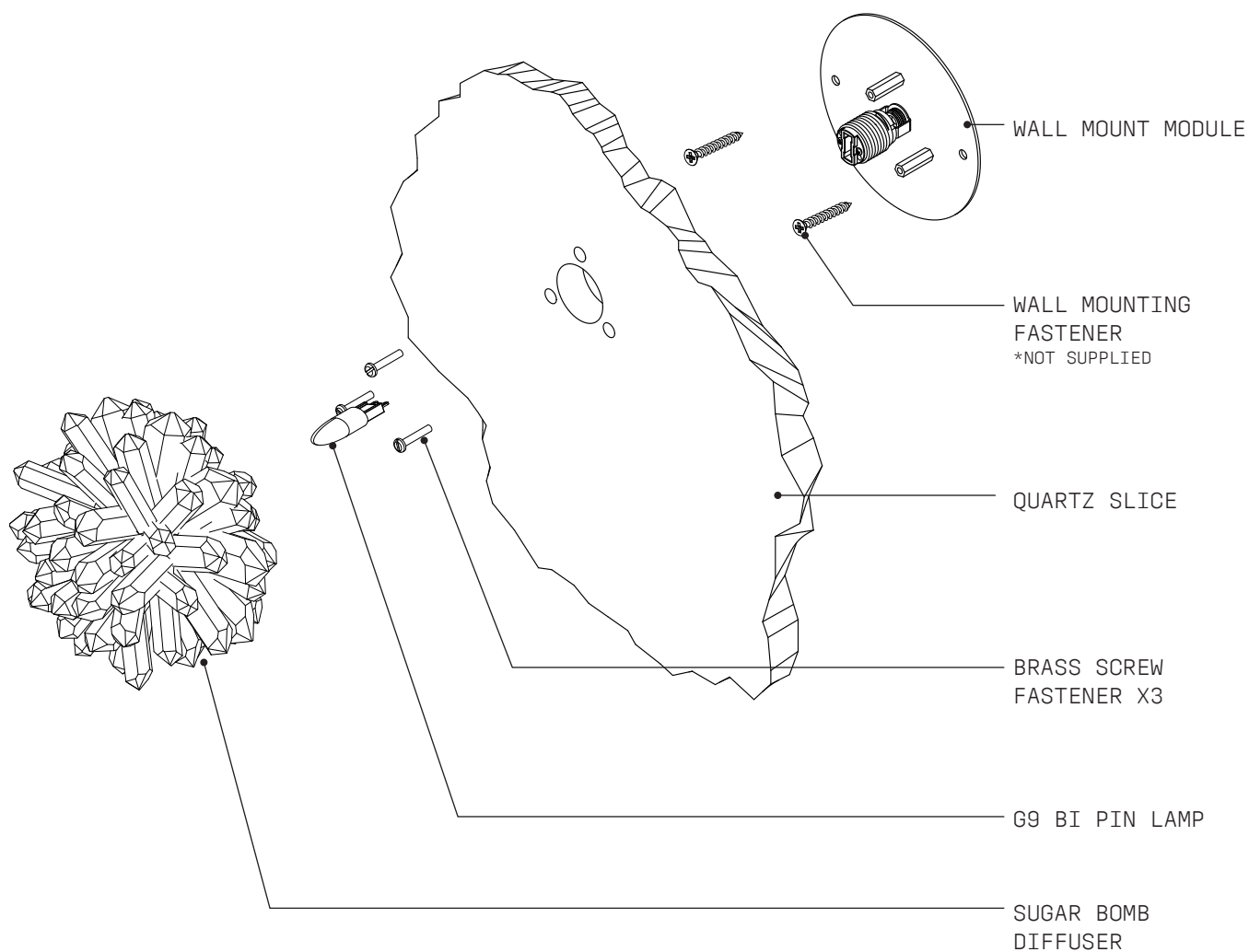



WARNING: SHOCK HAZARD

May result in serious injury or death.
ENSURE POWER IS OFF before commencing any work.



WARNING: ELECTRICAL

ALL ELECTRICAL connections must be made by a qualified electrician in accordance with the regulations and codes governing the area for which the CHRISTOPHER BOOTS Fixture is intended to be installed in. Failure to do so may result in serious harm or damage to property and life, at the owner's liability and expense.

CHRISTOPHER BOOTS will not be held liable for any damage caused from installation.



WARNING: STRUCTURAL

Ensure that the substrate is securely installed and is in accordance with local building regulations. Failure to do so may potentially result in serious harm or damage of property, at the owner's liability and expense.

CHRISTOPHER BOOTS will not be held liable for any damage caused from installation.

- 1 Wearing gloves, unpack SUGAR BOMB SCONCE with care, ensuring not to scratch component surfaces.
— Separate WALL MOUNT MODULE and mark out WALL FIXING HOLES & POWER FEED HOLE.

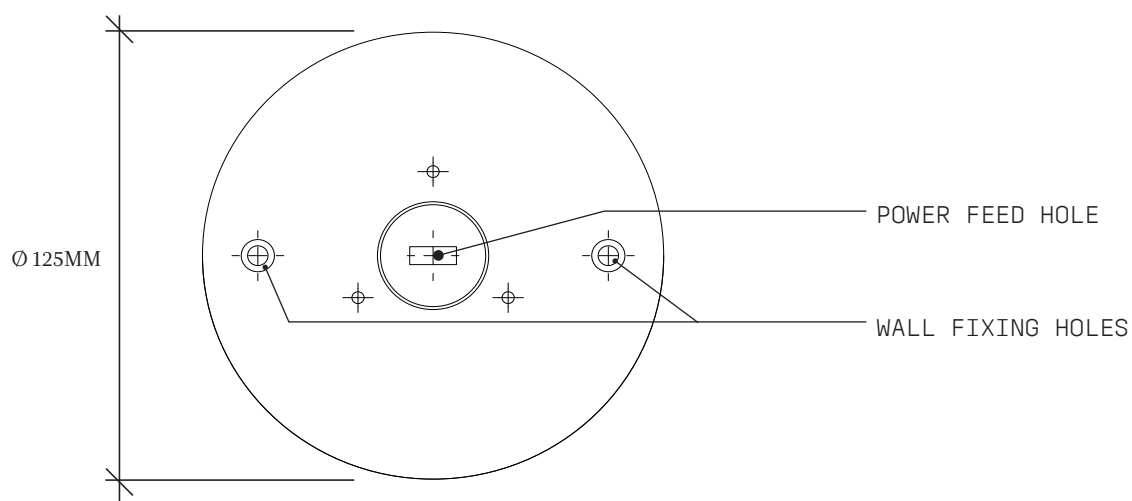

- 2 Remove WALL MOUNT MODULE and cut POWER FEED HOLE.

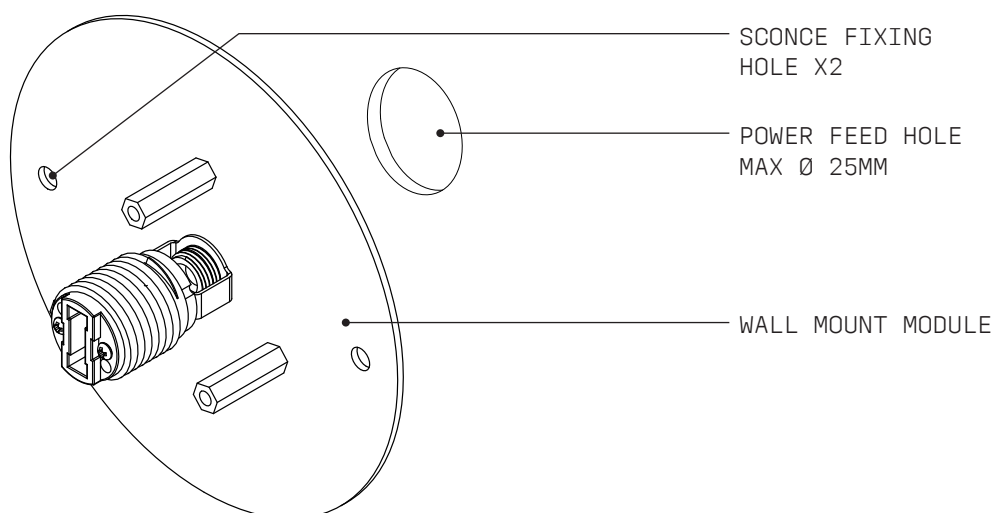

- 3 — Connect the 110-240V AC Power to the lamp holders.
Refer to supplied WIRING DIAGRAM →

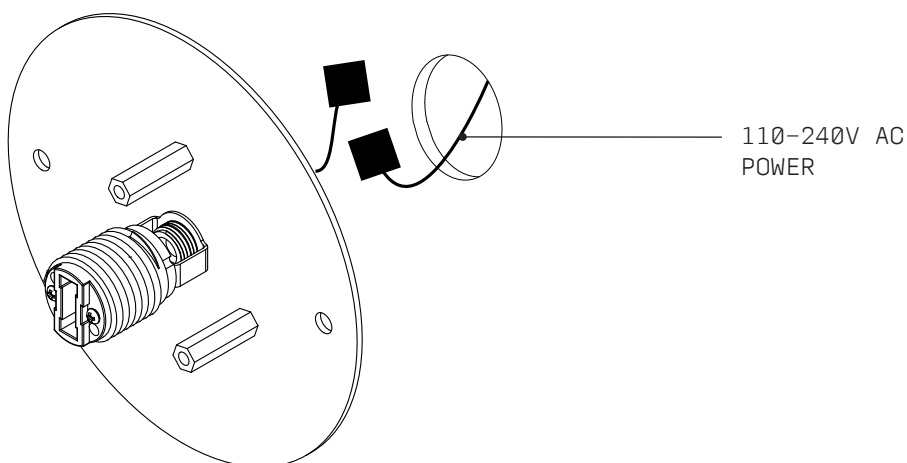

- 4 — With electrical connection made, push wiring into wall cavity and fix WALL MOUNT MODULE to adequate load bearing substrate.

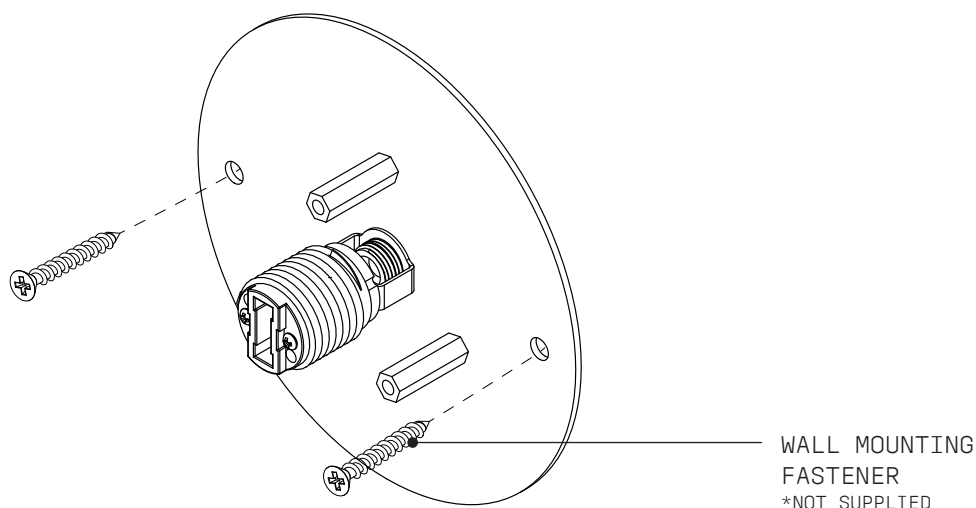

- 5 — With the WALL MOUNT MODULE installed, align and fit the QUARTZ SLICE with the three brass screw fasteners, ensure not to scratch or mark the disc. Insert the lamp and power on to ensure correct working order.

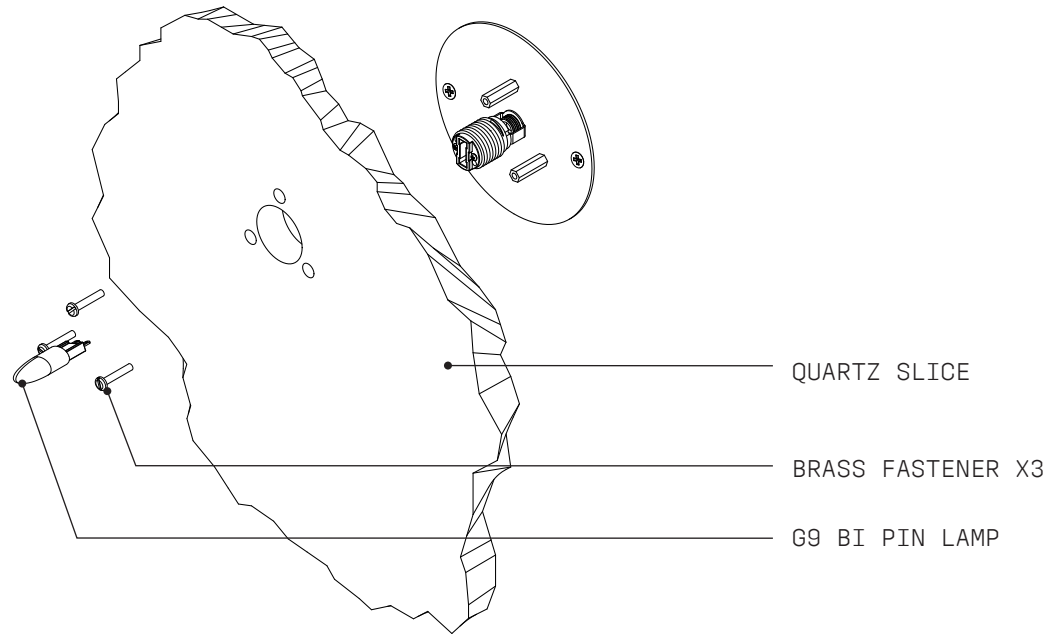

- 6 — Carefully screw on SUGAR BOMB DIFFUSER. These need only to be wound on by hand. Take care not to scratch the QUARTZ SLICE. Do not apply excessive turning pressure.

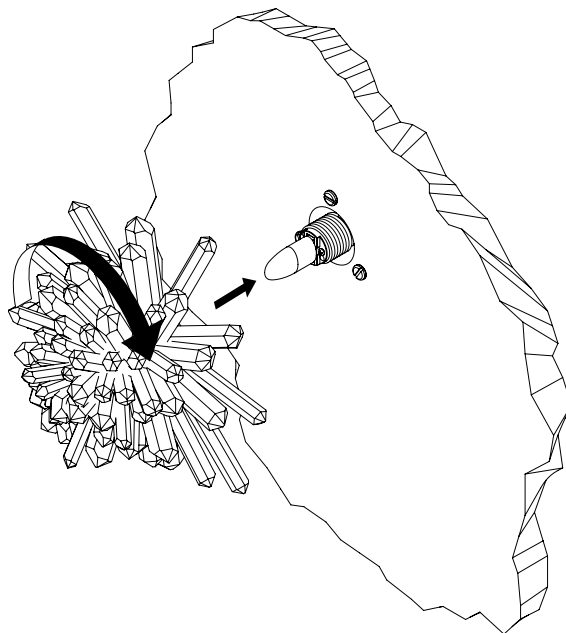

- 7 — Switch on SUGAR BOMB WALL SCENCE and conduct a final visual assessment to ensure all parts have been properly fitted and secured. Once satisfied that everything is in working order, the installation process is now complete.

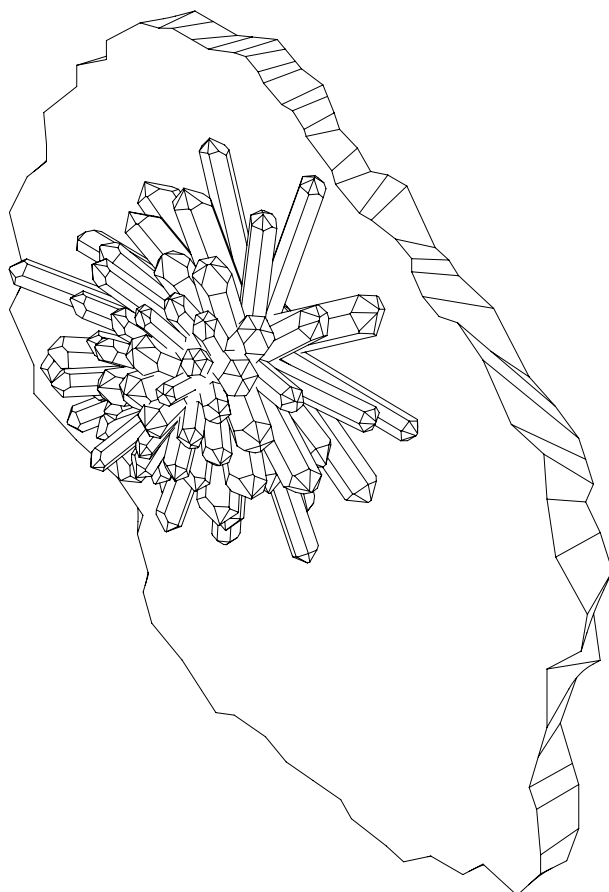

FINISH